

Quality Measure: During the measurement period, patients 12 years or older, screened for depression on the date of the encounter or up to 14 days prior to the date of the encounter using an age appropriate, standardized depression screening tool *and if positive, a follow-up plan is documented on the date of the eligible encounter. Patients with a diagnosis of depression are now included in the measure. The only exclusions are a bipolar diagnosis and a refusal to participate in the screening.*

When to Document a Follow-Up Plan

- If a patient scores a 5 or more on the PHQ-9/PHQ-A.
- If a patient scores a 10 or more on the **Edinburgh Postnatal Depression Scale**.

How to Document a Follow-Up Plan:

- If a patient meets the criteria above, a **SmartZone Alert** fires indicating **Depression Follow Up Needed**.

STEP 1: Select the alert to open the **Depression Follow-Up Plan PowerForm**.

STEP 2: Select **Planned Interventions**.

STEP 3: Review and enter appropriate diagnosis in the **Diagnoses and Problems** section.

Information

[Depression Follow Up Needed](#)

NOTE: Common Diagnoses are listed in the Depression Follow- Up section to assist with updating the Problem List.

Depression Follow-Up

Planned Interventions: (Select all that apply)

- Continue existing treatment plan
- Depression pharmacotherapy
- Positive PHQ-9/A follow-up visit
- Determined stable will follow-up (PRN) watchful waiting
- Referral to behavioral health
- Continue behavioral health
- Patient declined interventions
- Other:

Interpreting Scores:

Score	Score
Negative depression	0-4 < 4
Mild Depression	5-9 > 5-14
Moderate Depression	10-14 > 15
Moderately Severe Depression	15-19 > 15
Severe Depression	20-27 > 15

Diagnoses and Problems

Diagnosis (Problem) being Addressed this Visit

Clinical Dx	Annotated Display	Condition Name	Date	Code
Encounter for screening for depression	Encounter for screening f...	Encounter for screening f...	06/09/2024	Z13.31
Major depressive disorder, recurrent, ...	Major depressive disorder...	Major depressive disorder...	07/09/2024	F33.1

Problems

Annotated Display	Condition Name	Onset Date	Code	Name of Problem	Vocabulary	Life Cycle Sta...	Classification
Pregnancy	Pregnancy	05/01/2024	128451012	Pregnancy	SNOMED CT	Active	Medical

The PHQ-9 is adapted from PRIMEHOODDAY, developed by Drs. Robert L. Spitzer, Janet B.W. Williams, Kurt Kroenke, and colleagues, with an educational grant from Pfizer

See below for common diagnoses that meet specification criteria. Go to next section for diagnosis adjustment options.

- Major depressive disorder, recurrent, in remission, unspecified
- Major depressive disorder, recurrent, mild
- Major depressive disorder, recurrent, moderate
- Major depressive disorder, recurrent, severe with psychotic symptoms
- Major depressive disorder, single episode, in full remission
- Major depressive disorder, single episode, mild
- Major depressive disorder, single episode, moderate
- Major depressive disorder, single episode, severe with psychotic features

Additional Follow-Up Plan Options that Continue to Satisfy the Measure

Referral for Behavioral Health

- A referral is made to behavioral health for further evaluation/ intervention ordered on the same encounter as the positive depression screening.

Pharmacological Intervention

- A medication is ordered to address depression.

Follow Up Appointment

- Follow-Up appointment with PCP to address positive depression screening (for patients who do not meet criteria for Depression diagnosis).

Positive Depression Screening: Patient Does Not Meet Criteria for Depression Diagnosis

If a patient screens positive for depression, a **This Visit** problem, **Encounter for screening for depression (Z13.31)**, is automatically added if depression or a bipolar disorder are not already on the Problem List. This allows the provider to associate the problem to a follow-up appointment to meet the measure.

STEP 1: Complete the **PHQ-9, PHQ-A or Edinburgh Postnatal Depression Scale.**

STEP 2: Refresh the **Problem List.**

- A positive screen will automatically add a **This Visit** diagnosis to the problem list of **Encounter for screening for depression (Z13.31).**

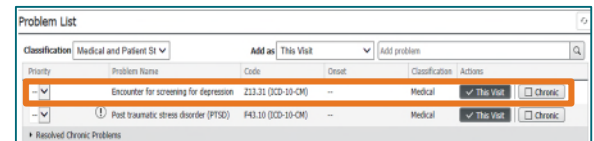

STEP 3: Select the appropriate **Follow-Up/Return to Clinic** order.

NOTE: There is not a specific time requirement for when the **Follow Up** appointment is made.

STEP 4: Select **Orders for Signature.**



STEP 5: Associate the diagnosis by clicking in the column below **Encounter for screening for depression (Z13.31).**

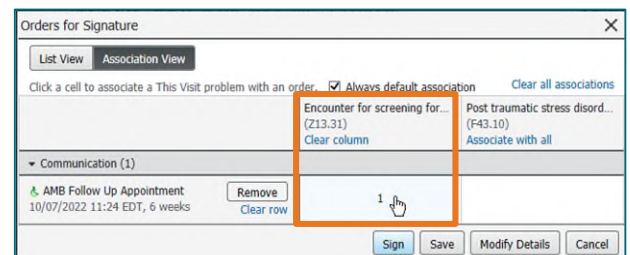

NOTE: Other diagnoses can also be associated in addition to the **Encounter for Screening for depression (Z13.31)** as appropriate.

STEP 6: Select **Sign** to satisfy the measure.